

WHEN  
**ONE**  
*Thrives,*  
**ALL**  
THRIVE.



  
**thrive**  
ALABAMA  
*Healthcare for You!*



“Thrive Alabama plays an important role in the delivery of primary healthcare in our community. By supporting Thrive Alabama’s capital campaign to expand its facilities and services you’re helping the organization serve more patients, while at the same time decreasing unnecessary visits to local emergency rooms.”

DAVID SPILLERS  
FMR CEO // HUNTSVILLE HOSPITAL

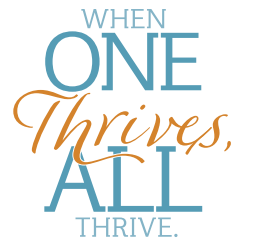

# HUNTSVILLE NEEDS HEALTHCARE

Imagine needing a primary care doctor, and finding none willing to accept patients with little to no insurance. Even people with insurance have difficulty finding physicians accepting new patients. **That’s the reality for 92,000 people in Madison County who have little to no access to primary healthcare.**

That’s one reason Thrive Alabama became a community health center. Our growth from a small clinic serving a specialized community to a health center caring for patients from all walks of life has been part of a strategic plan to meet the healthcare needs of our exploding population. This expansion will also allow us to fill the gap for unnecessary and costly ER visits, thereby saving our larger healthcare system emergency care funds.

**As a community health center,** Thrive Alabama offers holistic healthcare services that include:

- Adult primary healthcare
- Pediatrics
- Dental care
- Vision care
- Behavioral healthcare
- Social work services
- Nutritional counseling
- HIV prevention & education
- STI treatment
- Housing assistance
- Health insurance enrollment
- Transportation
- Medical translation services
- Specialty referrals

“A lot of people don’t get healthcare because they don’t have the means.

The only thing you can do is go to the emergency room sometimes. So to know that I can bypass that and come straight to a doctor who knows me and knows what’s going on and is going to take care of every aspect that I have going on is great. Everyone should have that. *There should be a Thrive Alabama in every city.*

RAFFORD SMITH  
PATIENT // VOLUNTEER



**29.6%** of people living in Madison County are below 200 percent of the Federal Poverty Level.



“ Thrive is one of those examples of somebody who’s going out and reaching out to a population that may not have a doctor at this time. And if we reach out to that doctor and get those citizens a doctor we can make sure that we have some of the best healthcare, not only in the state, but maybe the Southeast, and maybe the nation.”

TOMMY BATTLE  
MAYOR // CITY OF HUNTSVILLE



WHEN  
**ONE**  
*Thrives,*  
**ALL**  
THRIVE.

## OUR STORY

For over 30 years, Thrive Alabama has played a vital role in North Alabama’s health services landscape. We currently have clinics in Huntsville, Florence, and Albertville that serve 12 counties.

**1988** ■ A group of people responded to AIDS with love rather than fear and formed the AIDS Action Coalition of Huntsville (AAC). This band of volunteers provided food, assisted with rent, ran errands, paid utility bills, and, too often, helped people die with dignity.

**1992** ■ AAC opened a clinic for people living with HIV and added much needed support services.

**2000** ■ AAC received full funding from the Ryan White Care Act, a federal HIV/AIDS program, for \$325,000 allowing us to open more days in the clinic.

**2015** ■ With patients responding well to medical advancements and living long, healthy lives, AAC began expanding services to people without HIV and changed its name to Thrive Alabama.

**2018** ■ Thrive Alabama became a community health center and opened healthcare to people from all walks of life. We treat illnesses on an outpatient basis, often preventing chronic conditions from becoming more serious and expensive to treat.

### OUR MISSION

To empower our patients to create a healthy community by providing compassionate, accessible, affordable, comprehensive care.



**65%** of our patients are uninsured, on Medicaid, or on Medicare.

# ALL UNDER ONE ROOF

Our new healthcare center will meet the growing need for **primary healthcare, dental, vision, behavioral healthcare, and more** in the greater Huntsville area for both insured and uninsured people.

- LEVEL 1** Behavioral Healthcare  
Substance Abuse Services  
Community Pharmacy  
Laboratory  
Patient Food Pantry  
Patient Eligibility  
Classroom/Meeting Auditorium
- LEVEL 2** Adult Primary Healthcare  
Pediatrics  
Social Work
- LEVEL 3** Dental Care  
Vision Care  
PrEP Clinic  
Sexually Transmitted Infection Care  
Nutrition Services  
Health Education  
Administration

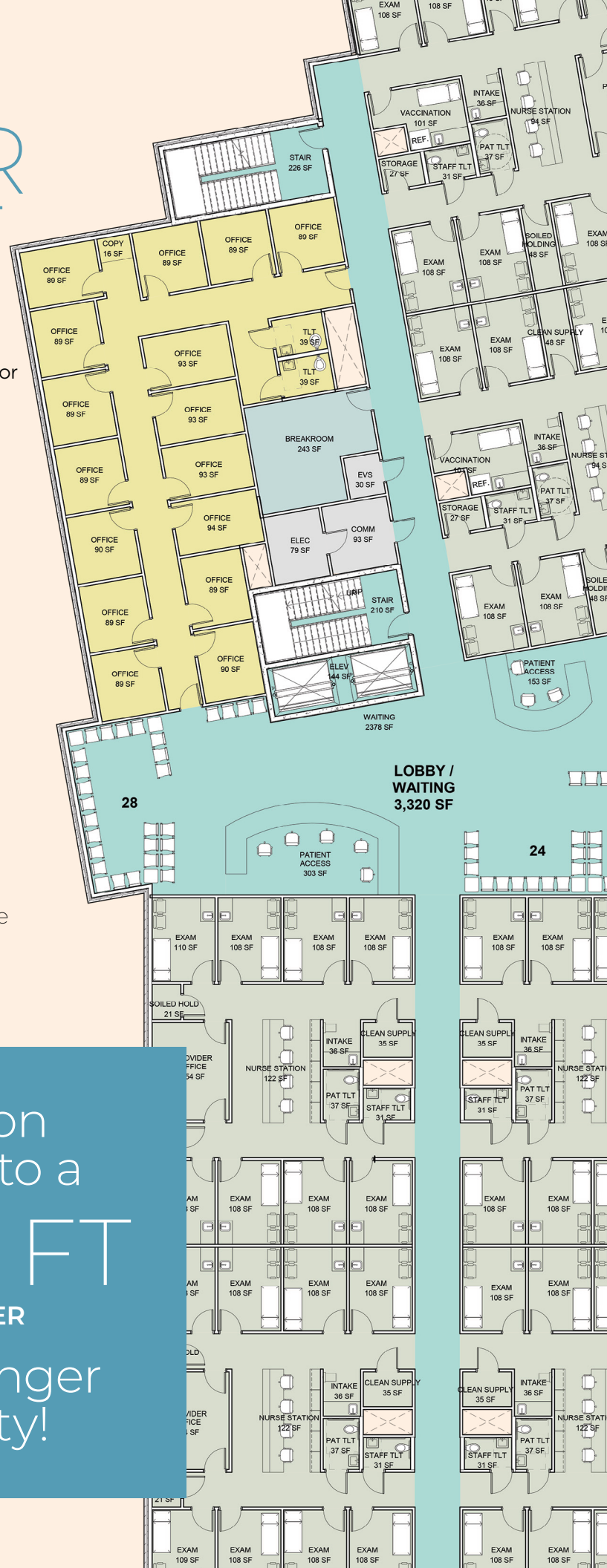

Our transformation from a small clinic to a **72,000 SQ. FT COMMUNITY HEALTH CENTER** is truly a game-changer for the community!

# GROWING TO SERVE

Expanding from multiple office locations in Huntsville to a state-of-the-art 72,000 sq. ft. health center isn't about having a bigger building. It's about having greater capacity to serve. **Currently we have 7,000 medical patients and project that number to increase to at least 14,000.** Our Huntsville staff will almost double including the caregivers below.

TODAY ▶ FUTURE





WHEN  
*ONE*  
*Thrives,*  
**ALL**  
THRIVE.

## REVITALIZING OUR CITY

**H**untsville is experiencing exciting growth with new businesses relocating here and major live, work, play developments under construction in all parts of our city. Yet, even with this growth, our community health needs assessment shows that over 92,000 people in Madison County have little to no access to quality healthcare.

In our new location at the corner of Oakwood Avenue and Washington Street, Thrive Alabama will meet the healthcare needs of thousands of Madison County friends and neighbors while contributing to the economic development of the area. We will:

**Offer convenient and holistic healthcare services** including primary care, pediatrics, and behavioral healthcare.

**Collaborate with our existing healthcare infrastructure** to decrease unneeded ER visits and save the system millions of dollars in uninsured medical costs.

**Provide compassionate care to everyone** regardless of their health condition, their income, or their insurance status.

**Help galvanize the revitalization of north Huntsville** already in a transformative phase featuring new homes and businesses, green spaces, and a multi-million dollar recreational facility.

We believe *When One Thrives, All Thrive*. Our commitment will always be to improve health outcomes for people in our community for decades to come.

**“The organization has got this attitude that they’re here to help and work with the clients and that’s just real clear. Whether it’s the person at the front desk, whether it’s someone on the board, or the medical staff. All of it is absolutely top notch. And I’m speaking from a good bit of personal experience. Decades of it.”**

SCHILD GRANT  
PATIENT // VOLUNTEER



“ I think it’s really important that industry and individuals support Thrive Alabama because it’s going to be able to provide complete healthcare for the family and the individual.”

KIMBERLY LEWIS  
CEO // PROJECT XYZ

# OUR TEAM



“I came to Thrive Alabama (AIDS Action Coalition) in 1992, four years after the organization began,

and in those early years, we sat around the board table trying to figure out how we were going to make it from one month to the next. After several years of being on the Board of Directors, I wanted to do more – I wanted to be with clients and be able to help with the programming and a bold vision for the future.

Today, we are quickly moving toward serving over 14,000 people annually with primary care, pediatrics, vision, dental, behavioral health, a lab, pharmacy, and more all under one roof. Now is the time we need the support of the whole community to help us see our mission through and realize the dream of providing quality healthcare to all of Madison County.”

MARY ELIZABETH MARR  
CHIEF EXECUTIVE OFFICER // THRIVE ALABAMA



“For almost three decades, Thrive Alabama has been a big part of my life. I’ve learned

through my experience with the agency that life is richer when we get outside of ourselves and help other people – even if it’s people we don’t know. I’ve observed how it has moved from a grassroots, largely volunteer group to today becoming a professionally managed, professionally run, comprehensive healthcare organization.

Thrive Alabama has become an organization that cares for all people regardless of their health condition, regardless of their ability to pay, regardless of whether or not they have health insurance. That is an ideal we should strive for in this country and Thrive Alabama is making that ideal a reality. I’m proud to support the *When One Thrives, All Thrive Campaign.*”

PATRICK ROBBINS  
CAMPAIGN CHAIR // THRIVE ALABAMA  
DIRECTOR // PROFESSIONAL SERVICES REVENUE CYCLE, HUNTSVILLE HOSPITAL

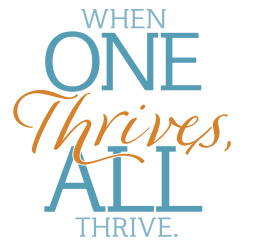

JITESH PARMAR  
CHIEF OPERATING OFFICER



STEPHANIE HARVILLE  
CHIEF FINANCIAL OFFICER



DR. MELINDA HOOTON  
CHIEF MEDICAL OFFICER

WHEN  
**ONE**  
*Thrives,*  
**ALL**  
THRIVE.

BE A PART OF OUR  
CAPITAL CAMPAIGN.

HELP US CREATE A  
HEALTHIER COMMUNITY.

[thrivealabama.org/donate](http://thrivealabama.org/donate)



Together, we can ensure that Thrive Alabama's legacy is ever evolving to meet the developing and changing needs of our community. Please join us in our campaign with your monetary gift, corporate sponsorships, gifts of stock, or through a planned gift such as bequests and charitable trusts.